

MNT-22

Mount for CPE / Subscriber and Small Base Station Antennas

MNT-22 Features:

- Azimuth and Elevation Adjustable Mount for CPE, Subscriber and Small Base Station Antennas
- Suitable for pole or wall mounting.
- Allows positioning of antenna in 45° slant polarization.
- Made of Die Cast Aluminum.
- Comes with all required hardware in a kit form.
- Heavy duty.

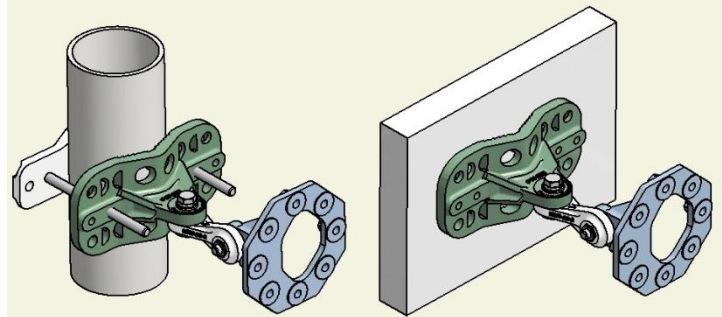

Specifications

Mechanical

Material	Aluminum
Kit Weight	0.820 kg.
Load	510 N
Suitable for pole diameter range	25-120 mm *Screws supplied are 80 mm. Longer screws are available on request.
Movement Possibility	Azimuth $\pm 45^\circ$ with antenna 300 x 300 mm mounted Elevation $\pm 45^\circ$ with antenna 300 x 300 mm mounted

Environmental

Operating Temperature Range	-40°C to +85°C
Vibration	According to IEC 60721-3-4
Flammability	UL94
Ice and Snow	25 mm radial (survival)
Wind Load	210 km/h
Humidity	ETS 300 019-1-4, EN 302 085 (annex A.1.1)

MARS Antennas & RF Systems proprietary information

MARS reserves the right to make technical changes or modifications to any of its products and specifications without prior notice and without implementing such changes to prior supplied products. Product images are representative and indicative only. Warranty terms and general conditions of sale are applicable on any purchase of any product, available on MARS website.

3 Hamanor st. Holon 5886103, P.O.Box 1852 Holon 5811801, Israel

Tel: +972-3-5599661 • Fax: +972-3-5599677 • e-mail: mars@marsant.co.il • web: www.mars-antennas.com